

Ø.17
Dia. (x4plcs)

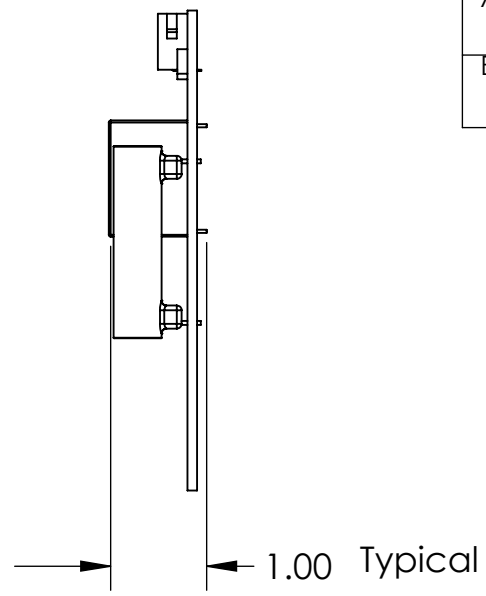

REVISIONS			
REV	INT	DESCRIPTION	DATE
A	KJM	Production Release per ECO #17-10770	5/5/17
B	MAI	Added weight of board per ECO #19-11114	9/11/19

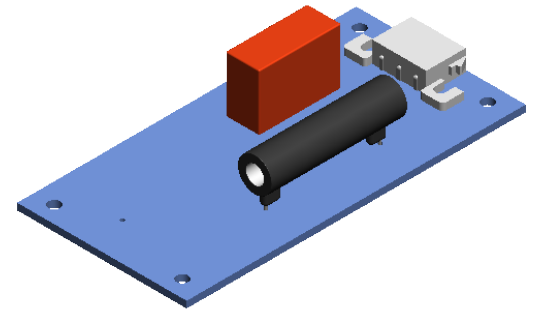

PROPRIETARY AND CONFIDENTIAL
THE INFORMATION CONTAINED IN THIS DRAWING IS THE SOLE PROPERTY OF ENERPRO, INC., GOLETA, CA USA. ANY REPRODUCTION IN PART OR AS A WHOLE WITHOUT THE WRITTEN PERMISSION OF ENERPRO, INC. IS PROHIBITED.

		UNLESS OTHERWISE SPECIFIED:	NAME	DATE
		DIMENSIONS ARE IN INCHES	DRAWN	jpm
		TOLERANCES:	CHECKED	
		FRACTIONAL ±	ENG APPR.	
		ANGULAR: MACH ± BEND ±	MFG APPR.	
		TWO PLACE DECIMAL ±	Q.A.	
		THREE PLACE DECIMAL ± .050"	COMMENTS:	
		INTERPRET GEOMETRIC TOLERANCING PER:		
		MATERIAL		
		FINISH		
NEXT ASSY	USED ON			
APPLICATION		DO NOT SCALE DRAWING		

ENERPRO, Inc. Goleta, CA USA		
TITLE: TSB-1 Snubber Board Physical		
SIZE A	DWG. NO. M2178	REV B
SCALE: 1:2	WEIGHT: 0.13lbs	SHEET 1 OF 1